



Raccords pression laiton

Raccord 90° fileté ITEM 153

Réf.	Description	P. Net	Vol. (m ³)	P. Brut	Lot
1020091	COUDE LAITON 90° FILETE 20-1/2"	0.118	0.00892	7.25	60
1020092	COUDE LAITON 90° FILETE 25-3/4"	0.184	0.00892	7.55	40
1020093	COUDE LAITON 90° FILETE 32-1"	0.297	0.00892	7.61	25
1020094	COUDE LAITON 90° FILETE 40-1 1/4"	0.488	0.02244	18.07	36
1020095	COUDE LAITON 90° FILETE 50-1 1/2"	0.745	0.02244	15.44	20
1020096	COUDE LAITON 90° FILETE 63-2"	1.238	0.01553	15.10	12
1020097	COUDE LAITON 90° FILETE 75-2 1/2"	1.831	0.02244	13.31	7
1020098	COUDE LAITON 90° FILETE 90-3"	2.436	0.02244	10.28	4



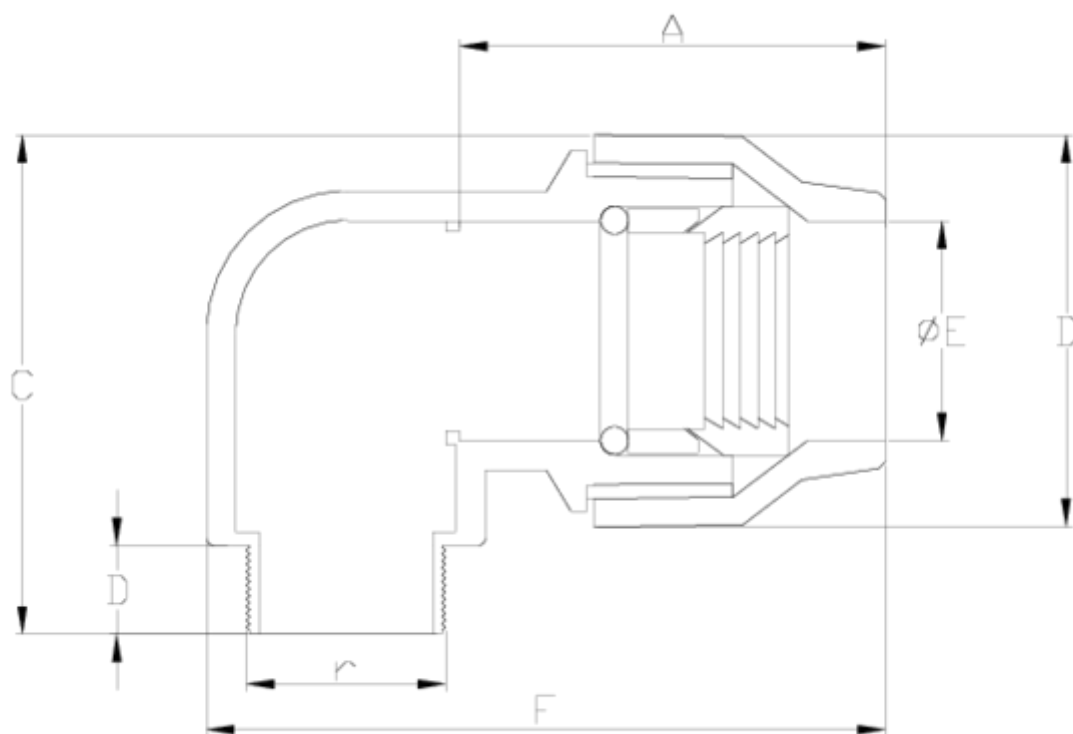

ITEM 153 | Raccord 90° fileté

Código	f tubo-R	Peso (g)	A	B	C	D	E	F	r	PN	TIPO ROSCA
20091	20-1/2"	125	31	35	42.5	9.199999999999999	21	55	1/2"	PN25	BSP
20092	25-3/4"	208	35	41.5	51.6	11	26	68	3/4"	PN25	BSP
20093	32-1"	272	42	49.5	63	14	33	75	1"	PN25	BSP
20094	40-1 1/4"	496	50	61	76	13.5	41.8	96	1 1/4"	PN25	BSP
20095	50-1 1/2"	745	52	74.3	95	14	51.2	108	1 1/2"	PN25	BSP
20096	63-2"	1238	63	91.2	108	15	64	135	2"	PN25	BSP
20097	75-2 1/2"	1735	135	95	110.8					PN25	BSP
20098	90-3"	2515	154	107	133.4					PN25	BSP



DOCUMENTS PRODUIT

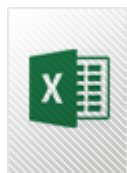

CERTIFICATS DE PRODUIT

CERTIFICATS D'ENTREPRISE

