



## Electrofusion fittings/Welding fittings

### Injected 90° tee ITEM 425

| Ref.    | Description          | Net Weight | Vol. (m <sup>3</sup> ) | Gross Weight | Units Box |
|---------|----------------------|------------|------------------------|--------------|-----------|
| 1019425 | INJECTED 90° TEE 63  | 0.343      | 0.03682                | 6.04         | 16        |
| 1019426 | INJECTED 90° TEE 75  | 0.600      | 0.03682                | 7.33         | 12        |
| 1019427 | INJECTED 90° TEE 90  | 0.845      | 0.04717                | 9.37         | 10        |
| 1019428 | INJECTED 90° TEE 110 | 1.491      | 0.08677                | 16.89        | 10        |
| 1019429 | INJECTED 90° TEE 125 | 2.154      | 0.08678                | 18.25        | 8         |
| 1019430 | INJECTED 90° TEE 140 | 2.932      | 0.08678                | 15.68        | 5         |
| 1019431 | INJECTED 90° TEE 160 | 4.159      | 0.08678                | 13.50        | 3         |
| 1019432 | INJECTED 90° TEE 180 | 6.230      | 0.06347                | 13.36        | 2         |
| 1019433 | INJECTED 90° TEE 200 | 8.100      | 0.03648                | 8.10         | 1         |
| 1019434 | INJECTED 90° TEE 225 | 10.070     | 0.06150                | 11.05        | 1         |
| 1019435 | INJECTED 90° TEE 250 | 14.040     | 0.08677                | 14.72        | 1         |
| 1019436 | INJECTED 90° TEE 280 | 21.880     | 0.00000                | 21.88        | 1         |
| 1019437 | INJECTED 90° TEE 315 | 28.770     | 0.00000                | 28.77        | 1         |



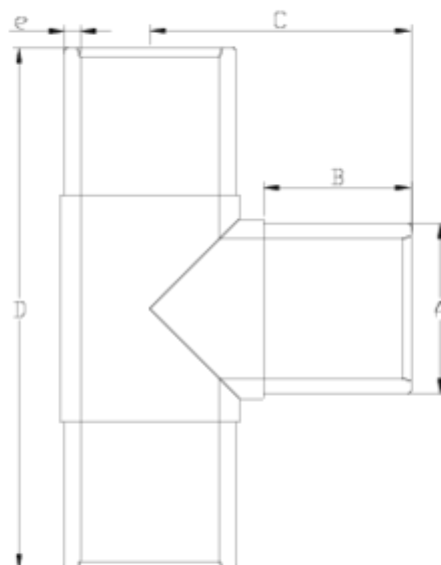

## ITEM 425 | Injected 90° tee

| Código | f tubo-A | Peso (g) | B   | C   | D   | e                 | PN   | MEDIDA  |
|--------|----------|----------|-----|-----|-----|-------------------|------|---------|
| 19425  | 63       | 375      | 70  | 114 | 228 | 5.8               | PN16 | MÉTRICO |
| 19426  | 75       | 616      | 73  | 120 | 240 | 6.8               | PN16 | MÉTRICO |
| 19427  | 90       | 1031     | 86  | 153 | 306 | 8.199999999999999 | PN16 | MÉTRICO |
| 19428  | 110      | 1660     | 95  | 168 | 336 | 10                | PN16 | MÉTRICO |
| 19429  | 125      | 2215     | 100 | 177 | 354 | 11.4              | PN16 | MÉTRICO |
| 19430  | 140      | 3200     | 105 | 193 | 386 | 12.7              | PN16 | MÉTRICO |
| 19431  | 160      | 4320     | 124 | 225 | 450 | 14.6              | PN16 | MÉTRICO |
| 19432  | 180      | 5980     | 119 | 233 | 466 | 16.4              | PN16 | MÉTRICO |
| 19433  | 200      | 7760     | 127 | 251 | 502 | 18.2              | PN16 | MÉTRICO |
| 19434  | 225      | 10485    | 138 | 272 | 544 | 20.5              | PN16 | MÉTRICO |



## ITEM 425 | Injected 90° tee

|       |     |       |     |     |     |      |             |         |
|-------|-----|-------|-----|-----|-----|------|-------------|---------|
| 19435 | 250 | 14780 | 148 | 314 | 628 | 22.7 | <b>PN16</b> | MÉTRICO |
| 19436 | 280 | 18670 | 160 | 346 | 692 | 25.4 | <b>PN16</b> | MÉTRICO |
| 19437 | 315 | 26150 | 170 | 380 | 760 | 28.6 | <b>PN16</b> | MÉTRICO |



## PRODUCT DOCUMENTS



## PRODUCT CERTIFICATES

## COMPANY CERTIFICATES

