

# 9 Ball valves & water taps

## Ball bibcocks

[Page 188](#)

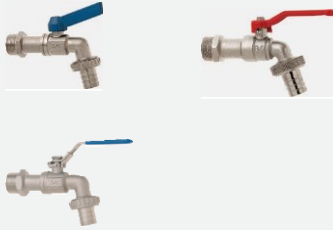

## Ball valves

[Page 189 - 197](#)

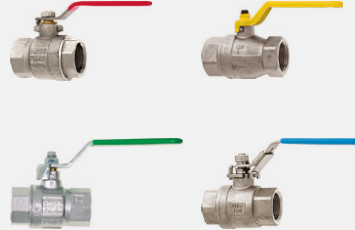

## Coupling slide gate valves

[Page 197](#)



## Water taps

[Page 198 - 199](#)





9



# GEKA® ball bibcocks

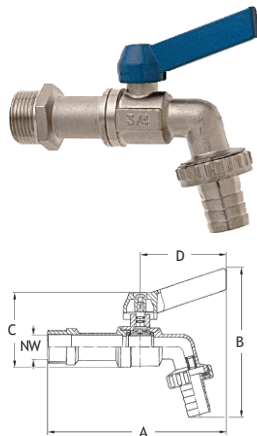

## GEKA® ball bibcocks, brass, nickel-plated

Material: ..... housing: brass, nickel-plated; spindle: brass, O-rings NBR;  
 ball: brass, hard chrome-plated, with PTFE seal rings;  
 lever: aluminium, blue; threaded hose fitting: brass, nickel-plated,  
 NBR flat seal rings, plastic insert

Operating pressure: ..... max. 15 bar  
 Operating temperature: ..... water from 0 °C to +80 °C, air from -15 °C to +110 °C

Male thread at inlet mm	20.95	26.44	33.25
<b>Male thread at inlet</b>	<b>G1/2</b>	<b>G3/4</b>	<b>G1</b>
<b>Nominal size</b>	<b>1/2"</b>	<b>3/4"</b>	<b>1"</b>
Male thread at outlet mm	26.44	33.25	41.91
Male thread at outlet	G3/4	G1	G1 1/4
Nominal width (NW) mm	10	12	15
A mm	103	114	133
B mm	96	104	133
C mm	44	51	54
D mm	56	56	56
PU units	10	6	5
Covering box units	60	36	20
Item no.	35.3501	35.3503	35.3504

## GEKA® ball bibcocks, low-duty version, brass, nickel-plated

Material: ..... housing: brass nickel-plated; ball: brass, hard chrome-plated,  
 PTFE seal rings; spindle with NBR O-ring; lever: steel, red;  
 threaded hose fitting: ABS nickel-plated, from 1" brass, nickel-plated,  
 NBR flat seal ring, plastic insert

Operating pressure: ..... max. 10 bar  
 Operating temperature: ..... water from 0 °C to +80 °C, air from -15 °C to +110 °C

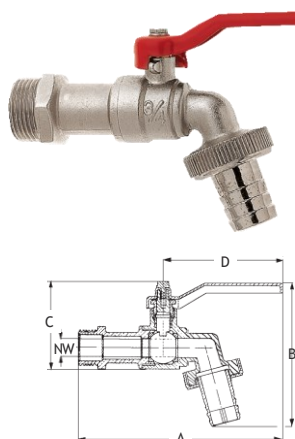

Male thread at inlet mm	20.95	26.44	33.25
<b>Male thread at inlet</b>	<b>G1/2</b>	<b>G3/4</b>	<b>G1</b>
<b>Nominal size</b>	<b>1/2"</b>	<b>3/4"</b>	<b>1"</b>
Male thread at outlet mm	26.44	33.25	41.91
Male thread at outlet	G3/4	G1	G1 1/4
Nominal width (NW) mm	9	12	15
Operating pressure max. bar	10	10	10
A mm	125	138	153
B mm	79	87	113
C mm	40	46	52
D mm	77	77	85
PU units	10	6	6
Covering box units	70	36	24
Item no.	35.3001	35.3003	35.3004



## GEKA® ball bibcocks, stainless steel

Material: ..... housing: stainless steel 1.4571; ball: stainless steel 1.4571,  
 PTFE seal rings  
 threaded hose connection: stainless steel 1.4571, NBR flat seal ring  
 lever, lever lock, bolt, washer: stainless steel 1.4301  
 spindle: stainless steel 1.4301, NBR O-rings; lever rubber coating:  
 PVC, blue

Operating pressure: ..... max. 15 bar  
 Operating temperature: ..... water from 0 °C to +80 °C, air from -15 °C to +110 °C



Male thread at inlet mm	20.95	26.44
<b>Male thread at inlet</b>	<b>G1/2</b>	<b>G3/4</b>
<b>Nominal size</b>	<b>1/2"</b>	<b>3/4"</b>
Male thread at outlet mm	26.44	33.25
Male thread at outlet	G3/4	G1
Nominal width (NW) mm	13	16
PU units	10	6
Covering box units	40	24
Item no.	35.3521	35.3523

**Special note:** Operating pressure dependent on the operating temperature. Data only represents approximate values. Therefore, no claim to absolute authority. No acceptance of guarantee. Dimensions and technical data subject to change.

## GEKA® ball valves type 7, brass, nickel-plated

Material:.....housing: brass nickel-plated; ball: brass, hard chrome-plated;  
spindle: brass; lever: steel, galvanised, handle cover: red

Operating temperature:.....water 0 °C to +100 °C, air -20 °C to +100 °C

Seal: .....ball with PTFE seal rings; spindle with two O-rings NBR

Note:.....full passage

### GEKA® ball valves with female thread

Female thread in mm	15.39	19.17	24.66	30.93	39.59
<b>Female thread</b>	<b>G3/8</b>	<b>G1/2</b>	<b>G3/4</b>	<b>G1</b>	<b>G1¼</b>
Female thread in mm	15.39	19.17	24.66	30.93	39.59
<b>Female thread</b>	<b>G3/8</b>	<b>G1/2</b>	<b>G3/4</b>	<b>G1</b>	<b>G1¼</b>
AF mm	21	24	30	38	46
Nominal width (NW) mm	10	15	20	25	32
Operating pressure max. bar	25	25	25	25	25
A mm	39	43	52	63	102
D mm	82	92	104	107	164
PU units	12	10	10	6	6
Covering box units	96	80	60	36	24
Item no.	67.7700	67.7701	67.7703	67.7704	67.7706

Female thread in mm	45.48	57.29	72.86	85.56
<b>Female thread</b>	<b>G1½</b>	<b>G2</b>	<b>G2½</b>	<b>G3</b>
Female thread in mm	45.48	57.29	72.86	85.56
<b>Female thread</b>	<b>G1½</b>	<b>G2</b>	<b>G2½</b>	<b>G3</b>
AF mm	53	65	81	96
Nominal width (NW) mm	40	50	65	80
Operating pressure max. bar	25	25	20	15
A mm	86	102	120	143
D mm	143	164	250	250
PU units	6	2	2	2
Covering box units	24	12	4	4
Item no.	67.7707	67.7709	67.7725	67.7730

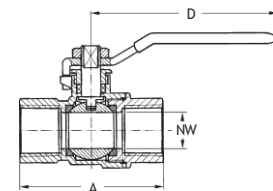

### GEKA® ball valves with female and male thread

Female thread in mm	15.39	19.17	24.66	30.93
<b>Female thread</b>	<b>G3/8</b>	<b>G1/2</b>	<b>G3/4</b>	<b>G1</b>
Male thread in mm	16.66	20.95	26.44	33.25
<b>Male thread</b>	<b>G3/8</b>	<b>G1/2</b>	<b>G3/4</b>	<b>G1</b>
AF mm	21	24	30	38
Nominal width (NW) mm	10	15	20	25
Operating pressure max. bar	25	25	25	25
A mm	43	51	61	72
D mm	82	92	104	107
PU units	12	10	10	6
Covering box units	96	80	60	36
Item no.	67.7800	67.7801	67.7803	67.7804

Female thread in mm	39.59	45.48	57.29
<b>Female thread</b>	<b>G1¼</b>	<b>G1½</b>	<b>G2</b>
Male thread in mm	41.91	47.80	59.61
<b>Male thread</b>	<b>G1¼</b>	<b>G1½</b>	<b>G2</b>
AF mm	46	53	65
Nominal width (NW) mm	32	40	50
Operating pressure max. bar	25	25	25
A mm	82	98	113
D mm	135	144	162
PU units	4	4	2
Covering box units	24	16	8
Item no.	67.7806	67.7807	67.7809

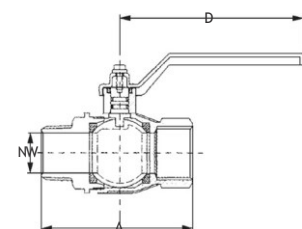

9

**Special note:** Operating pressure dependent on the operating temperature. Data only represents approximate values. Therefore, no claim to absolute authority. No acceptance of guarantee. Dimensions and technical data subject to change.



# GEKA® plus ball valves type 3, brass, nickel-plated

Material: ..... housing: brass nickel-plated; ball: brass, hard chrome-plated;  
 spindle: brass; lever: stainless steel, plastic-coated, red  
 Operating temperature: ..... water 0 °C to +100 °C; air -15 °C to +150 °C  
 Seal: ..... ball with PTFE seal rings; spindle with PTFE seal ring  
 Note: ..... full passage

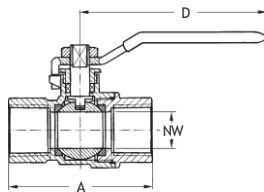
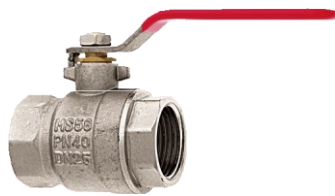

## GEKA® plus ball valves with female thread

Female thread in mm	11.89	15.39	19.17	24.66	30.93	39.59
<b>Female thread</b>	<b>G1/4</b>	<b>G3/8</b>	<b>G1/2</b>	<b>G3/4</b>	<b>G1</b>	<b>G1¼</b>
Female thread in mm	11.89	15.39	19.17	24.66	30.93	39.59
<b>Female thread</b>	<b>G1/4</b>	<b>G3/8</b>	<b>G1/2</b>	<b>G3/4</b>	<b>G1</b>	<b>G1¼</b>
AF mm	21	21	25	32	39	48
Nominal width (NW) mm	8	10	15	20	25	32
Operating pressure max. bar	40	40	40	40	40	30
A mm	46	46	52	58	69	81
D mm	88	89	102	102	108	139
PU units	12	12	10	6	6	4
Covering box units	96	96	80	48	36	24
Item no.	65.3314	65.3300	65.3301	65.3303	65.3304	65.3306

Female thread in mm	45.48	57.29	72.86	85.56	110.71
<b>Female thread</b>	<b>G1½</b>	<b>G2</b>	<b>G2½</b>	<b>G3</b>	<b>G4</b>
Female thread in mm	45.48	57.29	72.86	85.56	110.71
<b>Female thread</b>	<b>G1½</b>	<b>G2</b>	<b>G2½</b>	<b>G3</b>	<b>G4</b>
AF mm	56	67	83	97	122
Nominal width (NW) mm	40	50	65	80	100
Operating pressure max. bar	30	25	15	15	15
A mm	96	110	133	151	175
D mm	165	166	252	249	253
PU units	4	2	2	2	1
Covering box units	16	12	4	4	2
Item no.	65.3307	65.3309	65.3325	65.3330	65.3340

## GEKA® plus ball valves with female and male thread

Female thread in mm	15.39	19.17	24.66	30.93
<b>Female thread</b>	<b>G3/8</b>	<b>G1/2</b>	<b>G3/4</b>	<b>G1</b>
Male thread in mm	16.66	20.95	26.44	33.25
<b>Male thread</b>	<b>G3/8</b>	<b>G1/2</b>	<b>G3/4</b>	<b>G1</b>
AF mm	21	25	32	39
Nominal width (NW) mm	10	15	20	25
Operating pressure max. bar	40	40	40	40
A mm	53	59	62	78
D mm	89	101	101	109
PU units	10	10	6	6
Covering box units	80	80	36	24
Item no.	65.3400	65.3401	65.3403	65.3404

Female thread in mm	39.59	45.48	57.29
<b>Female thread</b>	<b>G1¼</b>	<b>G1½</b>	<b>G2</b>
Male thread in mm	41.91	47.80	59.61
<b>Male thread</b>	<b>G1¼</b>	<b>G1½</b>	<b>G2</b>
AF mm	48	56	67
Nominal width (NW) mm	32	40	50
Operating pressure max. bar	30	30	25
A mm	92	105	120
D mm	140	166	165
PU units	4	4	2
Covering box units	16	32	12
Item no.	65.3406	65.3407	65.3409

**Special note:** Operating pressure dependent on the operating temperature. Data only represents approximate values. Therefore, no claim to absolute authority. No acceptance of guarantee. Dimensions and technical data subject to change.

## Ball valves with male thread type 38, *brass, nickel-plated*

Material: ..... housing: brass CW617N, nickel-plated; ball: brass CW617N, hard chrome-plated;  
spindle: brass CW614N; lever: aluminium, painted, red

Operating temperature: ..... -20 °C to +100 °C

Seal: ..... ball with PTFE seal rings; spindle with PTFE O-ring and two NBR O-rings

Note: ..... full passage

### Ball valves with male thread

Male thread in mm	20.95	26.44	33.25
<b>Male thread</b>	<b>G1/2</b>	<b>G3/4</b>	<b>G1</b>
Male thread in mm	20.95	26.44	33.25
<b>Male thread</b>	<b>G1/2</b>	<b>G3/4</b>	<b>G1</b>
AF mm	25	31	40
Nominal width (NW) mm	14	19	25
Operating pressure max. bar	20	20	20
A mm	63	69	80
B mm	30	37	45
C mm	45	47	58
D mm	90	90	115
PU units	1	1	10
Covering box units	50	90	60
Item no.	65.3801	65.3803	65.3804

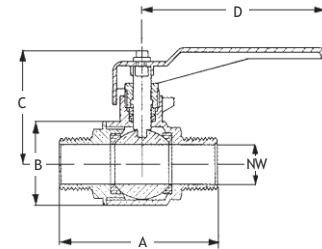

## Ball valves with female thread type 59, *brass, nickel-plated*

Material:..... housing: brass CW617N, nickel-plated; ball: brass CW617N, hard chrome-plated;  
spindle: brass CW614N; lever: aluminium, painted, black

Operating temperature: ..... -10 °C to +120 °C

Seal: ..... ball with PTFE seal rings (versions 68.5915, 68.5900 with two NBR O-rings and locking ring);  
spindle with two NBR seal rings (versions 68.5901, 68.5903, 68.5904, 68.5906, 68.5907,  
68.5909 with two PTFE seal rings)

Note:..... full passage

### Ball valves with female thread

Female thread in mm	11.89	15.39	19.17	24.66
<b>Female thread</b>	<b>G1/4</b>	<b>G3/8</b>	<b>G1/2</b>	<b>G3/4</b>
Female thread in mm	11.89	15.39	19.17	24.66
<b>Female thread</b>	<b>G1/4</b>	<b>G3/8</b>	<b>G1/2</b>	<b>G3/4</b>
AF mm	21	21	26	32
Nominal width (NW) mm	10	12	15	20
Operating pressure max. bar	50	50	45	45
A mm	50	50	60	72
C mm	52	52	55	66
D mm	84	84	90	125
PU units	15	1	20	12
Covering box units	-	15	80	48
Item no.	68.5915	68.5900	68.5901	68.5903

Female thread in mm	30.93	39.59	45.48	57.29
<b>Female thread</b>	<b>G1</b>	<b>G1¼</b>	<b>G1½</b>	<b>G2</b>
Female thread in mm	30.93	39.59	45.48	57.29
<b>Female thread</b>	<b>G1</b>	<b>G1¼</b>	<b>G1½</b>	<b>G2</b>
AF mm	40	50	56	68
Nominal width (NW) mm	25	32	40	50
Operating pressure max. bar	40	35	35	35
A mm	82	94	105	126
C mm	70	93	98	110
D mm	125	145	145	170
PU units	6	1	3	2
Covering box units	36	16	12	8
Item no.	68.5904	68.5906	68.5907	68.5909

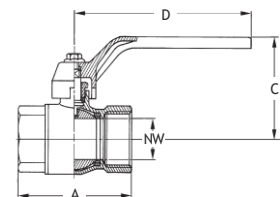

9

**Special note:** Operating pressure dependent on the operating temperature. Data only represents approximate values. Therefore, no claim to absolute authority. No acceptance of guarantee. Dimensions and technical data subject to change.





## Gas ball valves, *brass, nickel-plated*

Quality information: .....DIN DVGW NG-4312BN7046, MOP 5  
 Material:.....housing: brass CW617N, nickel-plated; ball: brass CW617N, hard chrome-plated;  
 spindle: brass CW614N; lever: sheet steel, galvanised, powder-coated, yellow  
 Gas operating pressure:.....max. 5 bar as per DIN EN 331  
 Operating temperature:.....water 0 °C to +100 °C; air -20 °C to +220 °C  
 Seal: .....ball with PTFE seal rings; spindle with FKM O-ring (fluororubber) as per DIN ISO 1629  
 and NBR O-ring  
 Note:.....**full passage**

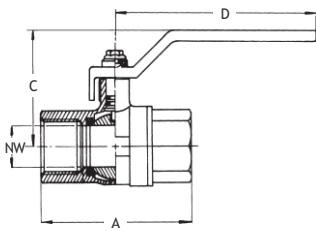

### Gas ball valves DIN DVGW with female thread

Female thread in mm	11.89	15.39	19.17	24.66
<b>Female thread</b>	<b>R1/4</b>	<b>R3/8</b>	<b>R1/2</b>	<b>R3/4</b>
Female thread in mm	11.89	15.39	19.17	24.66
<b>Female thread</b>	<b>R1/4</b>	<b>R3/8</b>	<b>R1/2</b>	<b>R3/4</b>
AF mm	18	21	25	31
Nominal width (NW) mm	10	10	15	20
Operating pressure max. bar	50	50	50	40
Gas operating pressure max. bar	5	5	5	5
A mm	51	60	75	80
C mm	40	40	50	59
D mm	80	80	89	113
PU units	12	12	12	8
Covering box units	-	156	96	40
<b>Item no.</b>	<b>68.5614</b>	<b>68.5600</b>	<b>68.5601</b>	<b>68.5603</b>

Female thread in mm	30.93	39.59	45.48	57.29
<b>Female thread</b>	<b>R1</b>	<b>R1¼</b>	<b>R1½</b>	<b>R2</b>
Female thread in mm	30.93	39.59	45.48	57.29
<b>Female thread</b>	<b>R1</b>	<b>R1¼</b>	<b>R1½</b>	<b>R2</b>
AF mm	40	49	54	68.5
Nominal width (NW) mm	25	32	40	50
Operating pressure max. bar	40	30	30	25
Gas operating pressure max. bar	5	5	5	5
A mm	90	110	120	140
C mm	63	77	91	97
D mm	113	138	157.3	157.3
PU units	6	4	2	2
Covering box units	30	24	18	10
<b>Item no.</b>	<b>68.5604</b>	<b>68.5606</b>	<b>68.5607</b>	<b>68.5609</b>

**Special note:** Operating pressure dependent on the operating temperature. Data only represents approximate values. Therefore, no claim to absolute authority. No acceptance of guarantee. Dimensions and technical data subject to change.



## Three-way ball valves form L and T, *brass, nickel-plated*

Material:.....housing: brass CW617N, nickel-plated; ball: brass CW617N, hard chrome-plated;  
spindle: brass CW614N; lever: aluminium, painted, red

Operating temperature:.....-20 °C to +100 °C

Seal: .....ball with PTFE seal rings; spindle with FKM seal ring (fluororubber) as per DIN ISO 1629

Annotation:.....full passage

### Three-way ball valves form L

Female thread in mm	11.89	15.39	19.17	24.66
<b>Female thread</b>	<b>G1/4</b>	<b>G3/8</b>	<b>G1/2</b>	<b>G3/4</b>
Nominal width (NW) mm	10	12	14	18
Operating pressure max. bar	25	25	25	25
A mm	77	77	77	92
B mm	39	39	39	47
C mm	85	85	85	107
D mm	125	125	125	145
G mm	58	58	58	70
PU units	4	4	4	2
Covering box units	32	32	32	16
<b>Item no.</b>	<b>65.4514</b>	<b>65.4500</b>	<b>65.4501</b>	<b>65.4503</b>

Female thread in mm	30.93	39.59	45.48	57.29
<b>Female thread</b>	<b>G1</b>	<b>G1¼</b>	<b>G1½</b>	<b>G2</b>
Nominal width (NW) mm	23	29	36	45
Operating pressure max. bar	25	25	25	25
A mm	104	118	138	162
B mm	55	65	79	93
C mm	124	134	145	186
D mm	170	170	170	280
G mm	80	92	109	128
PU units	2	2	2	2
Covering box units	12	10	8	4
<b>Item no.</b>	<b>65.4504</b>	<b>65.4506</b>	<b>65.4507</b>	<b>65.4509</b>

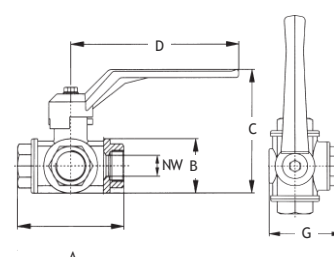
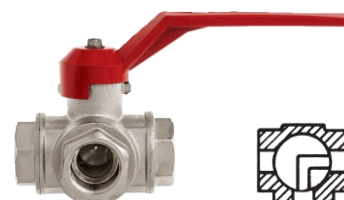

### Three-way ball valves form T

Female thread in mm	11.89	15.39	19.17	24.66
<b>Female thread</b>	<b>G1/4</b>	<b>G3/8</b>	<b>G1/2</b>	<b>G3/4</b>
Nominal width (NW) mm	10	12	14	18
Operating pressure max. bar	25	25	25	25
A mm	77	77	77	92
B mm	39	39	39	47
C mm	85	85	85	107
D mm	125	125	125	145
G mm	58	58	58	70
PU units	4	2	4	2
Covering box units	32	-	32	16
<b>Item no.</b>	<b>65.4414</b>	<b>65.4400</b>	<b>65.4401</b>	<b>65.4403</b>

Female thread in mm	30.93	39.59	45.48	57.29
<b>Female thread</b>	<b>G1</b>	<b>G1¼</b>	<b>G1½</b>	<b>G2</b>
Nominal width (NW) mm	23	29	36	45
Operating pressure max. bar	25	25	25	25
A mm	104	118	138	162
B mm	55	65	79	93
C mm	124	134	145	186
D mm	170	170	170	280
G mm	80	92	109	128
PU units	2	2	2	2
Covering box units	12	12	6	4
<b>Item no.</b>	<b>65.4404</b>	<b>65.4406</b>	<b>65.4407</b>	<b>65.4409</b>

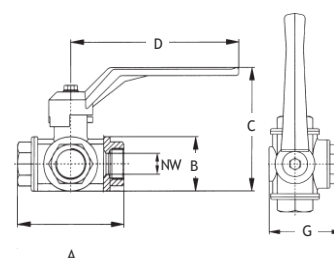
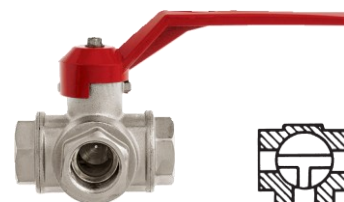

9

**Special note:** Operating pressure dependent on the operating temperature. Data only represents approximate values. Therefore, no claim to absolute authority. No acceptance of guarantee. Dimensions and technical data subject to change.





# Drinking water ball valves, *brass, nickel-plated*

Material:.....housing: brass CW617N, nickel-plated; ball: brass CW617N, hard chrome-plated; spindle: brass CW614N; lever: steel, plastic-coated, green

Operating temperature:.....water 0 °C to +100 °C; air -20 °C to +100 °C

Seal: .....ball with PTFE seal rings; spindle with two O-rings NBR and FKM (fluororubber) as per DIN ISO 1629

Note:.....full passage

## Drinking water ball valves DIN DVGW with female thread

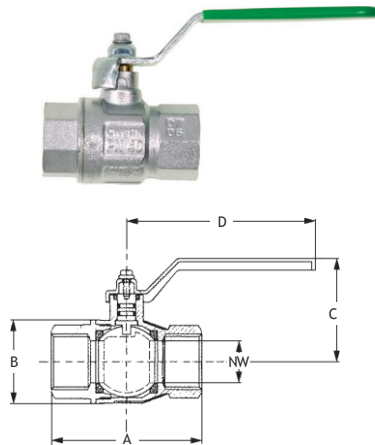

Female thread in mm	15.39	19.17	24.66	30.93	39.59	45.48	57.29
<b>Female thread</b>	<b>G3/8</b>	<b>G1/2</b>	<b>G3/4</b>	<b>G1</b>	<b>G1¼</b>	<b>G1½</b>	<b>G2</b>
Female thread in mm	15.39	19.17	24.66	30.93	39.59	45.48	57.29
<b>Female thread</b>	<b>G3/8</b>	<b>G1/2</b>	<b>G3/4</b>	<b>G1</b>	<b>G1¼</b>	<b>G1½</b>	<b>G2</b>
AF mm	21	25	31	38	47	54	66
Nominal width (NW) mm	10	15	20	25	32	40	50
Operating pressure max. bar	50	50	40	40	30	30	25
A mm	52	61	68	85	100	109	130
B mm	24	31	37	46	58	71	85
C mm	42	50	56	60	77	92	99
D mm	86	93	114	114	138	158	158
PU units	12	10	8	6	4	2	2
Item no.	02.9100	02.9101	02.9103	02.9104	02.9106	02.9107	02.9109

## Drinking water ball valves DIN DVGW with female and male thread

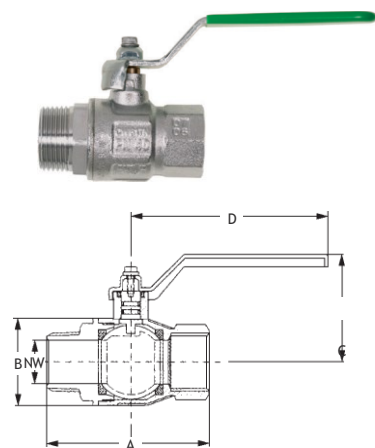

Female thread in mm	15.39	19.17	24.66	30.93	39.59	45.48	57.29
<b>Female thread</b>	<b>G3/8</b>	<b>G1/2</b>	<b>G3/4</b>	<b>G1</b>	<b>G1¼</b>	<b>G1½</b>	<b>G2</b>
Male thread in mm	16.66	20.95	26.44	33.25	41.91	47.80	59.61
<b>Male thread</b>	<b>R3/8</b>	<b>R1/2</b>	<b>R3/4</b>	<b>R1</b>	<b>R1¼</b>	<b>R1½</b>	<b>R2</b>
AF mm	21	25	31	38	47	54	66
Nominal width (NW) mm	10	15	20	25	32	40	50
Operating pressure max. bar	50	50	40	40	30	30	25
A mm	59	68	76	91	105	116	136
B mm	24	31	37	46	58	71	85
C mm	42	50	56	60	77	92	99
D mm	86	93	114	114	138	158	158
PU units	12	10	8	6	4	2	2
Item no.	02.9200	02.9201	02.9203	02.9204	02.9206	02.9207	02.9209

9

**Special note:** Operating pressure dependent on the operating temperature. Data only represents approximate values. Therefore, no claim to absolute authority. No acceptance of guarantee. Dimensions and technical data subject to change.

## Ball valves, stainless steel

Advantage / benefit:.....with lever locking device

Material:.....housing, ball: stainless steel 1.4408; spindle: stainless steel 1.4401;  
 lever: stainless steel 1.4301, plastic-coated, blue

Operating pressure: .....max. 70 bar at +90 °C

Seal: .....ball with PTFE seal rings; spindle with two PTFE seal rings

Note:.....full passage

### Ball valves, 2-piece, stainless steel

Female thread in mm	11.89	15.39	19.17	24.66
<b>Female thread</b>	<b>G1/4</b>	<b>G3/8</b>	<b>G1/2</b>	<b>G3/4</b>
Female thread in mm	11.89	15.39	19.17	24.66
<b>Female thread</b>	<b>G1/4</b>	<b>G3/8</b>	<b>G1/2</b>	<b>G3/4</b>
AF mm	22	22	26	32
Nominal width (NW) mm	11	13	15	20
Operating pressure at +90 °C bar	70	70	70	70
Operating pressure at +150 °C bar	40	40	40	40
Operating pressure at +200 °C bar	15	15	15	15
A mm	53	51	60	71
D mm	103	103	103	126
PU units	10	10	10	5
Item no.	65.3020	65.3021	65.3022	65.3023

Female thread in mm	30.93	39.59	45.48	57.29
<b>Female thread</b>	<b>G1</b>	<b>G1¼</b>	<b>G1½</b>	<b>G2</b>
Female thread in mm	30.93	39.59	45.48	57.29
<b>Female thread</b>	<b>G1</b>	<b>G1¼</b>	<b>G1½</b>	<b>G2</b>
AF mm	40	48	56	70
Nominal width (NW) mm	25	32	38	50
Operating pressure at +90 °C bar	70	70	70	70
Operating pressure at +150 °C bar	40	40	40	40
Operating pressure at +200 °C bar	15	15	15	15
A mm	84	99	105	120
D mm	144	144	194	197
PU units	5	2	2	2
Item no.	65.3024	65.3025	65.3026	65.3027

Material:.....brass nickel-plated; ball: hard chrome-plated with O-rings PTFE;  
 toggle: stainless steel,  
 painted in red; ball valve 50.5649.9: plastic

Seal: .....flat seal ring at the female thread

### GEKA® ball valves for watering wands

Female thread in mm	19.17	24.66	24.66	24.66
<b>Female thread</b>	<b>G1/2</b>	<b>G3/4</b>	<b>G3/4</b>	<b>G3/4</b>
Male thread in mm	26.44	26.44	26.44	26.44
<b>Male thread</b>	<b>G3/4</b>	<b>G3/4</b>	<b>G3/4</b>	<b>G3/4</b>
Nominal size in mm	13	13	13	13
<b>Nominal size</b>	<b>1/2"</b>	<b>1/2"</b>	<b>1/2"</b>	<b>1/2"</b>
Approx. length in mm	69	53	53	65
PU units	10	10	10	10
Covering box units	60	50	100	140
Item no.	51.5469.9	51.5471	50.5548	50.5649



51.5469.9 for Soft Rain KX, multi and multisport



51.5471 for universal washer



50.5548 for Soft Rain, Vario and sport



50.5649 for Soft Rain and Soft Rain PX

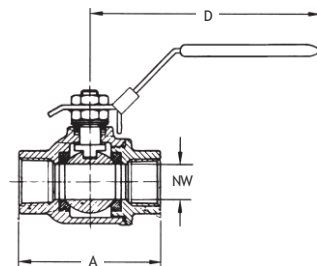

GEKA® ball valves for watering wands

## Ball valves with wing handle, *brass, nickel-plated*

Material:.....housing: brass nickel-plated; ball: brass, hard chrome-plated;  
 spindle: brass; wing handle: aluminium, painted in red  
 Operating temperature:.....water 0 °C to +100 °C; air -15 °C to +220 °C  
 Seal: .....ball with PTFE seal rings; spindle with FKM O-ring (fluororubber) as per DIN ISO 1629  
 and NBR O-ring  
 Note:.....full passage

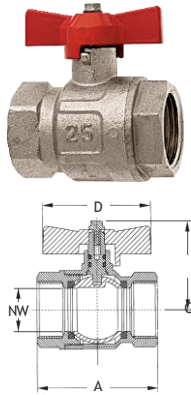

### Ball valves with female thread

Female thread in mm	11.89	15.39	19.17	24.66	30.93
<b>Female thread</b>	<b>G1/4</b>	<b>G3/8</b>	<b>G1/2</b>	<b>G3/4</b>	<b>G1</b>
Female thread in mm	11.89	15.39	19.17	24.66	30.93
<b>Female thread</b>	<b>G1/4</b>	<b>G3/8</b>	<b>G1/2</b>	<b>G3/4</b>	<b>G1</b>
AF mm	23.5	24	30.5	37	45.5
Nominal width (NW) mm	10	10	15	20	25
Operating pressure max. bar	40	40	40	40	40
A mm	44	44	52	57	69
C mm	36.5	36.5	40	48	52
D mm	47	47	47	62	62
PU units	15	20	12	8	8
Covering box units	120	120	72	48	32
Item no.	18.5814	18.5890	18.5891	18.5893	18.5894

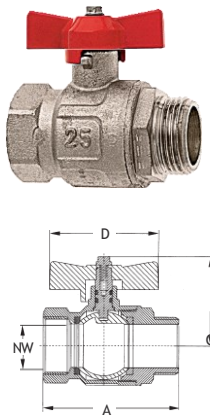

### Ball valves with female and male thread

Female thread in mm	11.89	15.39	19.17	24.66	30.93
<b>Female thread</b>	<b>G1/4</b>	<b>G3/8</b>	<b>G1/2</b>	<b>G3/4</b>	<b>G1</b>
Male thread in mm	13.16	16.66	20.95	26.44	33.25
<b>Male thread</b>	<b>G1/4</b>	<b>G3/8</b>	<b>G1/2</b>	<b>G3/4</b>	<b>G1</b>
AF mm	24	24	31	37	46
Nominal width (NW) mm	10	10	15	20	25
Operating pressure max. bar	40	40	40	40	40
A mm	55	55	59	65	77
C mm	37	37	40	48	52
D mm	47	47	47	62	62
PU units	12	15	12	6	8
Covering box units	120	90	72	60	32
Item no.	18.5914	18.5990	18.5991	18.5993	18.5994

## GEKA® mini ball valves, *brass, chrome-plated*

Material:.....housing: brass, chrome-plated; ball: brass, hard chrome-plated;  
 spindle: brass; T-handle: plastic, nylon red  
 Operating pressure: .....max. 15 bar  
 Operating temperature: .....water 0 °C to +90 °C; air -15 °C to +110 °C  
 Seal: .....ball with PTFE seal rings; spindle with O-ring NBR  
 Note:.....reduced passage

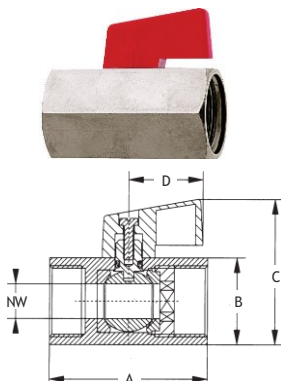

### GEKA® mini ball valves with female thread

Female thread in mm	8.85	11.89	15.39	19.17	24.66
<b>Female thread</b>	<b>G1/8</b>	<b>G1/4</b>	<b>G3/8</b>	<b>G1/2</b>	<b>G3/4</b>
Female thread in mm	8.85	11.89	15.39	19.17	24.66
<b>Female thread</b>	<b>G1/8</b>	<b>G1/4</b>	<b>G3/8</b>	<b>G1/2</b>	<b>G3/4</b>
Nominal width (NW) mm	6	8	8	10	12
Length (A) mm	40	40	40	46	52
Hexagon AF (B) mm	21	21	21	25	30
C mm	38	38	38	42	48
D mm	22	22	22	22	22
PU units	20	20	20	20	15
Covering box units	120	120	140	120	60
Item no.	65.4618	65.4614	65.4600	65.4601	65.4603

**Special note:** Operating pressure dependent on the operating temperature. Data only represents approximate values. Therefore, no claim to absolute authority. No acceptance of guarantee. Dimensions and technical data subject to change.

## GEKA® mini ball valves, *brass, chrome-plated*

Material:.....housing: brass, chrome-plated; ball: brass, hard chrome-plated;  
spindle: brass; T-handle: plastic nylon

Operating pressure: .....max. 15 bar

Operating temperature: .....water 0 °C to +90 °C; air -15 °C to +110 °C

Seal: .....ball with PTFE seal rings; spindle with O-ring NBR

Colour: .....T-handle red

Note:.....**reduced passage**

### GEKA® mini ball valves with female and male thread

Female thread in mm	8.85	11.89	15.39	19.17	24.66
Female thread	G1/8	G1/4	G3/8	G1/2	G3/4
Male thread in mm	9.73	13.16	16.66	20.95	26.44
Male thread	G1/8	G1/4	G3/8	G1/2	G3/4
Nominal width (NW) mm	6	8	8	10	12
Length (A) mm	40	39	40	48	54
Hexagon AF (B) mm	21	21	21	25	30
C mm	38	38	38	42	48
D mm	22	22	22	22	22
PU units	25	30	25	25	18
Covering box units	150	180	200	150	108
Item no.	65.4718	65.4714	65.4700	65.4701	65.4703

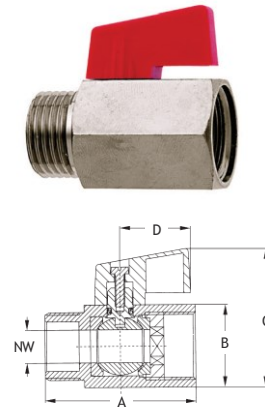

## Coupling slide gate valves

Material:.....brass; handwheel: sheet steel, painted

Operating temperature: .....max. +100 °C

Seal: .....spindle with NBR seal rings

Colour: .....handwheel: red

Note:.....metal-sealing

### Coupling slide gate valves with female thread

Female thread in mm	19.17	24.66	30.93	39.59	45.48
Female thread	G1/2	G3/4	G1	G1¼	G1½
Female thread in mm	19.17	24.66	30.93	39.59	45.48
Female thread	G1/2	G3/4	G1	G1¼	G1½
AF mm	24	30	37	46	52
Nominal width (NW) mm	13	15	19	27	33
Operating pressure max. bar	10	10	10	10	10
A mm	34	40	44	51	52
D mm	44	44	48	54	70
PU units	20	12	6	5	10
Covering box units	180	80	36	50	18
Item no.	35.0211	35.0213	35.0214	35.0216	35.0217
Female thread in mm	57.29	72.86	85.56	110.71	
Female thread	G2	G2½	G3	G4	
Female thread in mm	57.29	72.86	85.56	110.71	
Female thread	G2	G2½	G3	G4	
AF mm	65	83	94	120	
Nominal width (NW) mm	42	59	68	78	
Operating pressure max. bar	10	10	10	10	
A mm	56	62	74	82	
D mm	70	100	108	130	
PU units	5	1	1	1	
Covering box units	18	8	8	2	
Item no.	35.0219	35.0225	35.0230	35.0240	

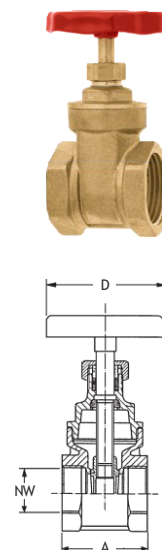

9

**Special note:** Operating pressure dependent on the operating temperature. Data only represents approximate values. Therefore, no claim to absolute authority. No acceptance of guarantee. Dimensions and technical data subject to change.



## GEKA® plus design water taps



GEKA® plus  
push-fit system



### GEKA® plus design water taps

Advantage /benefit: ..... design water tap with GEKA® plus connector plug  
can be combined with all standard push-fit systems  
and hose types  
**long-lasting and easy to operate**

Material: ..... brass, chrome-plated

Area of application: ..... for garden, house, workshop, etc.

Male thread at inlet mm	20.95	20.95	26.44	26.44
Male thread at inlet	G1/2	G1/2	G3/4	G3/4
Male thread at outlet mm		26.44		33.25
Male thread at outlet		G3/4		G1
Connection	GEKA® plus push-fit system	Grommet 1/2"	GEKA® plus push-fit system	Grommet 3/4"
PU units	1	1	1	1
Covering box units	30	7	30	30
Item no.	46.8121	46.8122.9	46.8123	46.8124.9

## Water taps

### Water taps with threaded hose fitting

Material: ..... valve body, upper part of valve: brass;  
grommet: brass sheet with plastic insert  
for concentrated medium flow

Connection: ..... male thread and threaded hose fitting at water outlet



Male thread at inlet mm	20.95	20.95	20.95	20.95	26.44
Male thread at inlet	G1/2	G1/2	G1/2	G1/2	G3/4
Nominal size in mm	13	13	13	13	19
Nominal size	1/2"	1/2"	1/2"	1/2"	3/4"
Male thread at outlet mm	26.44	26.44	26.44	26.44	33.25
Male thread at outlet	G3/4	G3/4	G3/4	G3/4	G1
Hose ID mm	13	13	13	13	19
Surface	matt	polished	matt, chrome-plated	polished, chrome-plated	matt
PU units	10	5	10	1	1
Covering box units	50	30	60	40	30
Item no.	36.0021	36.0121	36.2121	36.1121	36.0023
Male thread at inlet mm	26.44	26.44	26.44	33.25	
Male thread at inlet	G3/4	G3/4	G3/4	G1	
Nominal size in mm	19	19	19	25	
Nominal size	3/4"	3/4"	3/4"	1"	
Male thread at outlet mm	33.25	33.25	33.25	41.91	
Male thread at outlet	G1	G1	G1	G1 1/4	
Hose ID mm	19	19	19	25	
Surface	polished	matt, chrome-plated	polished, chrome-plated	matt, chrome-plated	
PU units	5	5	1	1	
Covering box units	30	30	30	20	
Item no.	36.0123	36.2123	36.1123	36.2124	

## Water taps

### Water taps with return flow stopper, brass, chrome-plated

Connection: ..... male thread and threaded hose fitting at water outlet,  
 with return flow stopper and pipe vent DIN DVGW 734 V

Male thread at inlet mm	20.95	26.44
<b>Male thread at inlet</b>	<b>G1/2</b>	<b>G3/4</b>
Nominal size in mm	13	19
<b>Nominal size</b>	<b>1/2"</b>	<b>3/4"</b>
Male thread at outlet mm	26.44	26.44
Male thread at outlet	G3/4	G3/4
Hose ID mm	13	19
Surface	matt, chrome-plated	matt, chrome-plated
PU units	1	1
Covering box units	40	28
Item no.	36.4210	36.4230

