



## PP pressure fittings

### "AIR" 90° elbow ITEM 543

Ref.	Description	Net Weight	Vol. (m <sup>3</sup> )	Gross Weight	Units Box
1012211	"AIR" 90° ELBOW EQUAL OUTLETS 25-1/2"	0.152	0.03129	8.19	50
1012212	"AIR" 90° ELBOW EQUAL OUTLETS 25-3/4"	0.149	0.03129	8.03	50
1012213	"AIR" 90° ELBOW EQUAL OUTLETS 32-3/4"	0.251	0.03648	9.38	35
1012214	"AIR" 90° ELBOW EQUAL OUTLETS 32-1"	0.238	0.04460	9.11	35
1012215	"AIR" 90° ELBOW EQUAL OUTLETS 40-3/4"	0.388	0.04460	10.44	25
1012216	"AIR" 90° ELBOW EQUAL OUTLETS 40-1"	0.352	0.04460	9.63	25
1012217	"AIR" 90° ELBOW EQUAL OUTLETS 50-3/4"	0.250	0.04460	4.58	15
1012218	"AIR" 90° ELBOW EQUAL OUTLETS 50-1"	0.250	0.04460	4.58	15
1012209	"AIR" 90° ELBOW EQUAL OUTLETS 63-3/4"	0.975	0.06347	15.53	15
1012210	"AIR" 90° ELBOW EQUAL OUTLETS 63-1"	0.979	0.06347	15.59	15



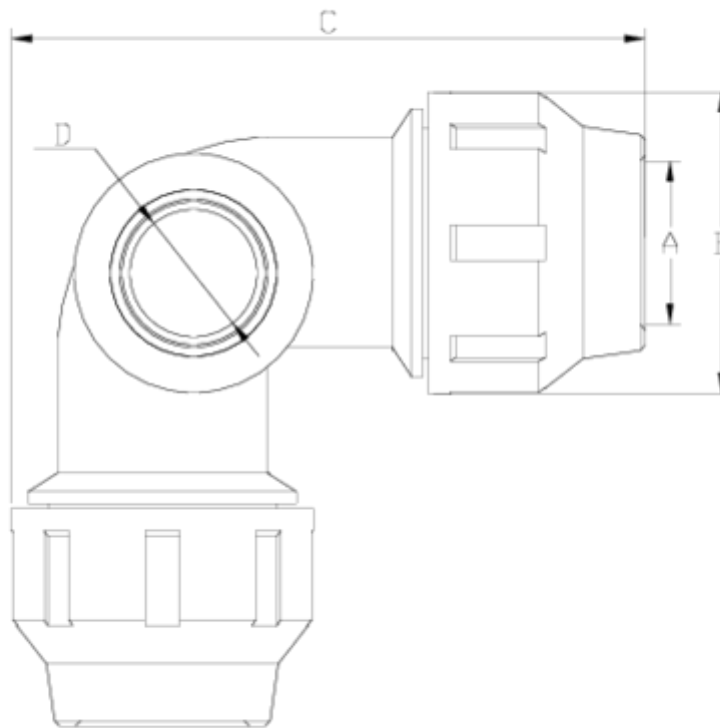

## ITEM 543 | "AIR" 90° elbow

Código	f tubo - D	Peso (g)	A	B	C	PN	ROSCA
12211	25 - 1/2"	147	26	55	115	PN16	BSP
12212	25 - 3/4"	152	26	55	115	PN16	BSP
12213	32 - 3/4"	216	33	64	132	PN16	BSP
12214	32 - 1"	222	33	64	132	PN16	BSP
12215	40 - 3/4"	347	42	76	155	PN16	BSP
12216	40 - 1"	352	42	76	155	PN16	BSP
12217	50 - 3/4"	550	51	91	173	PN16	BSP
12218	50 - 1"	556	51	91	173	PN16	BSP
12209	63 - 3/4"	955	64	109	205	PN16	BSP
12210	63 - 1"	945	64	109	205	PN16	BSP



## ITEM 543 | "AIR" 90° elbow



## PRODUCT DOCUMENTS



## PRODUCT CERTIFICATES

## COMPANY CERTIFICATES

