



PP pressure fittings

90° elbow, male threaded ITEM 104

Ref.	Description	Net Weight	Vol. (m ³)	Gross Weight	Units Box
1012091	90° ELBOW ,MALE THREAD 20-1/2"	0.060	0.02244	5.32	80
1012092	90° ELBOW ,MALE THREAD 25-3/4"	0.087	0.02244	4.85	50
1012093	90° ELBOW ,MALE THREAD 32-1"	0.137	0.03129	7.43	50
1012094	90° ELBOW ,MALE THREAD 40-1 1/4"	0.235	0.03648	7.63	30
1012095	90° ELBOW ,MALE THREAD 50-1 1/2"	0.398	0.03648	8.55	20
1012096	90° ELBOW ,MALE THREAD 63-2"	0.727	0.04717	11.54	15
1012097	90° ELBOW ,MALE THREAD 75-2 1/2"	1.113	0.06150	12.06	10
1012098	90° ELBOW ,MALE THREAD 90-3"	1.898	0.03129	8.17	4
1012099	90° ELBOW ,MALE THREAD 110-4"	2.831	0.03129	6.24	2
1012361	CODO 90° ROSCA MACHO 25-1/2"	0.090	0.02243	4.92	50
1012364	CODO 90° ROSCA MACHO 32-3/4"	0.135	0.03129	7.38	50



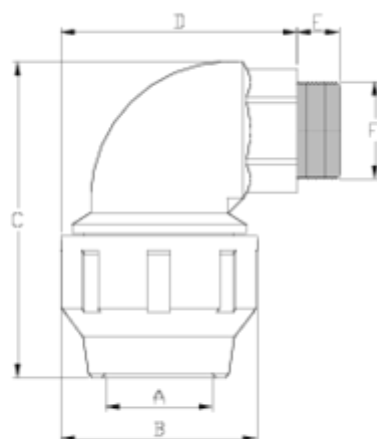

ITEM 104 | 90° elbow, male threaded

Código	f tubo - F	Peso (g)	A	B	C	D	E	PN	TIPO ROSCA
12091	20 - 1/2"	60	21	46	83	77	15	PN16	BSP
12361	25 - 1/2"	87	26	55	92	81	15	PN16	BSP
12092	25 - 3/4"	90	26	55	92	81	15	PN16	BSP
12364	32 - 3/4"	129	33	64	105	94	15	PN16	BSP
12093	32 - 1"	134	33	64	105	94	17	PN16	BSP
12094	40 - 1 1/4"	227	42	76	126	104	21	PN16	BSP
12095	50 - 1 1/2"	370	51	91	145	128	21	PN16	BSP
12096	63 - 2"	612	64	109	189	156	29	PN16	BSP
12097	75 - 2 1/2"	1057	77	133	212	178	30	PN10	BSP
12098	90 - 3"	1919	92	159	263	208	35	PN10	BSP



ITEM 104 | 90° elbow, male threaded

12099	110 - 4"	2769	112	183	303	244	41	PN10	BSP
-------	----------	------	-----	-----	-----	-----	----	------	-----



PRODUCT DOCUMENTS



PRODUCT CERTIFICATES

COMPANY CERTIFICATES

